

# HARTLEPOOL VCS

## NEWS

**Events | Sector Connector 56 notes | Vacancies | Your Views –  
Consultations & Feedback | Funding selection | Recent Research**

Sector Connector 57 will be taking place on the 1st March at  
Greenbank 10am-11:15am

---

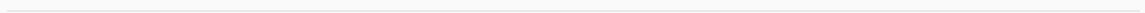

## [Quick Navigation](#)

[Notices](#)

[Upcoming Events](#)

[Room Availability](#)

[Sector Connector Notes](#)

[Vacancies - paid & voluntary](#)

[Your views: Consultation & feedback](#)

[A selection of funding opportunities](#)

[Training Support](#)

[Recent Research](#)

---

## **Have your say**

Are you wanting to promote an event, course or vacancy?

If you would like a space in the Hartlepower Newsletter, please get in touch

with: [JamesIrvin@hartlepower.co.uk](mailto:JamesIrvin@hartlepower.co.uk).



# Notices

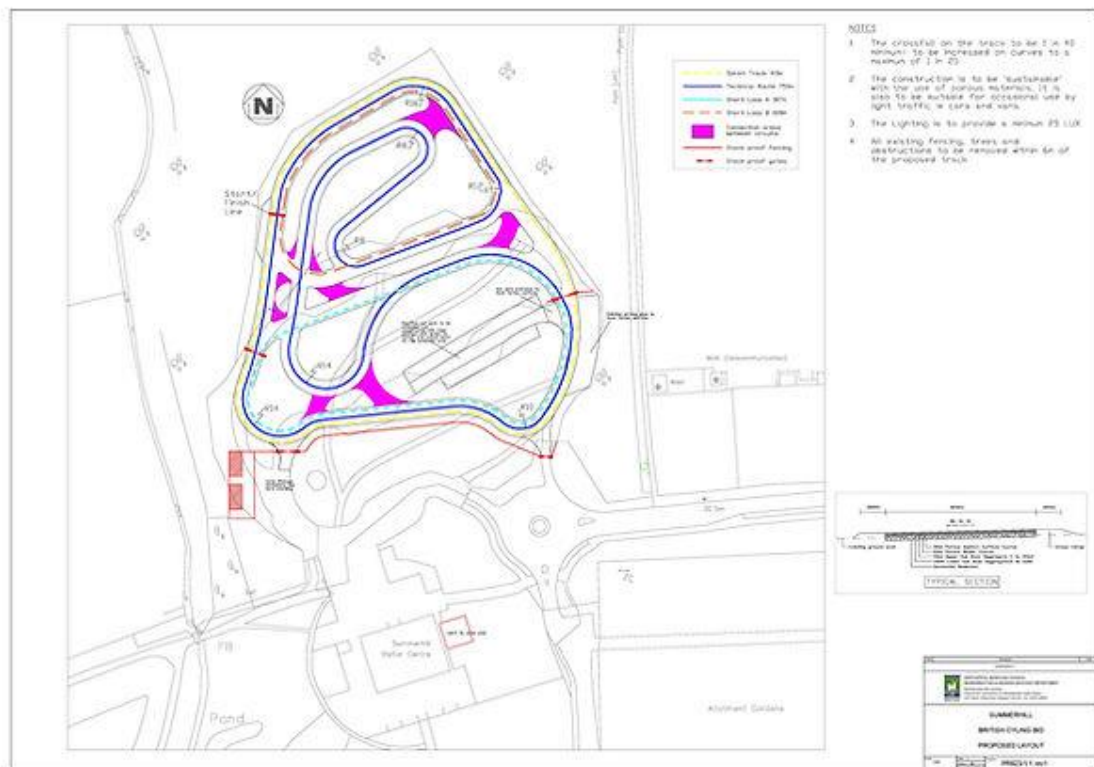

## New opening of Summerhill Cycle Track encourages stakeholder involvement from the sector

Work has now commenced on the new activity area at the former overflow carpark area at Summerhill Country park

The fenced and floodlit track is aimed at encouraging everyone – whatever their ability – to cycle more safely and more often.

Once construction is complete (Expected by May), the project will also support people to further develop their cycling skills in track and BMX, in partnership with several local clubs.

The visitor centre will also be open to reflect the opening times of the track and the cafe area

**The comprises of:**

- A 750-metre “free-form” tarmac, fenced and floodlit cycle track incorporating varying elevations and degrees of cornering difficulty
- A dedicated balance bike and learn-to-ride area, for younger people keen to learn new skills
- Spectator fencing and a warmup/cool down area on the existing BMX track
- Two secure cycle storage containers

HBC, VCS and sports organisations came together last week to talk through the development of the activity and discuss plans for a launch in May 2022.

If your organisation would like to potentially be involved in a launch day for the site or would like to contribute to an ongoing working group please get in touch.

[Julisimons@hartlepower.org.uk](mailto:Julisimons@hartlepower.org.uk)

---



**23rd February:** Family activity day at the Supporters Club 12-3pm. Hosted by Victoria Ward Partnership Community Engagement Team.

**26th February:** Happy Health Hub Chinese Cooking Course, 11:30-1:00pm, contact [wen.cai@btinternet.com](mailto:wen.cai@btinternet.com) for any questions.

**27th February:** Greatham Snowdrop Day 2022, Greatham Community Centre  
1-4:00pm.

**1st March:** Sector Connector 57 Live at Greenbank, 10-11:15am.

**1st March/8th March:** Women's Wellbeing Club, The Arches, 6-8:00pm

**15th March:** Sector Connector 58 Zoom, 10-11:15am.

---

## **Room Availability**

We have plenty of rooms available for functions and new spaces available in Hartlepower Hubs 1 & 2. If you are interested in finding out more information, please get in touch with Clair Gilbraith via: ClairGilbraith@hartlepower.co.uk or call 01429 806400 and select option 2.



---

## **Sector Connector Notes**

---

### **Attendee list:**

Angela Dyer - Igneus

Hannah Goodman – Covid Engagement Officer

Jan Grey - Hartlepool Action Lab JRHT

Juli Simons - Hartlepower

---

Angela Dyer - Igneus CRS (commission and rehabilitation services)

Angela works with those who are leaving jail to reacclimatize to the world around them. This can be through supporting needs, 1-1 and groupwork before signposting and working alongside. This reduces their barriers to reintegrating themselves into society. There are 11 offices in the North East, which do take referrals from Hartlepool. Angela is hoping to find other services who can help facilitate her mission.

**Get in touch:** [Adyer@ingeus.co.uk](mailto:Adyer@ingeus.co.uk)

---

Hannah Goodman – Covid Engagement Officer

Hannah is hoping to expand on her network of Covid champions (people who give out information about Covid that Hannah has condensed from the government). This is a simple process where you sign up for emails from her. Hannah has been instrumental in spreading the vaccination clinics throughout the locale of Hartlepool as well as simplifying the guidance that has been given out.

**Get in touch:** [Hannah.Goodman@hartlepool.gov.uk](mailto:Hannah.Goodman@hartlepool.gov.uk)

---

Jan Grey - Hartlepool Action Lab JRHT

Looking to find practical solutions to poverty. Jan has a busy schedule with the Monthly Save Money Hartlepool campaign, helping to put money back in the pockets of the people of Hartlepool through budgeting, healthy eating, food, fuel and internet issues. Two of these events will be held, the first at Belle Vue- Feb 23<sup>rd</sup> and the Supporters Club after. As well as March 23<sup>rd</sup> at the Clippy Club. Housing Heroes is taking place to provide help to residents with paying bills and food shopping. Warm Handover is a scheme where people attending the Job Centre can receive help from experts while making their claim, while also assisting job coaches to better understand their clients while helping them.

**Get in touch:** [Janette.Grey@jrht.org.uk](mailto:Janette.Grey@jrht.org.uk)

---



Juli Simons - [Hartlepower](#)

Alongside facilitating communications between the VCS and the town of Hartlepool, Juli has been working alongside the Victoria Ward Partnership to assist in the development of that ward of the town. The main aims of this are to strengthen the community and develop individuals within communities. Rachael and Stephanie (community engagement officers) have been supporting integration of services in the area and building key relationships with ward members. Currently the Partnership have a base of 30 families to work with and a new sporting organisation popping up in the form of Hartlepool Huskies. Key areas to work on have been identified as; housing changes and the role that VCS organisations can play.

**Get in touch:** [JuliSimons@hartlepower.co.uk](mailto:JuliSimons@hartlepower.co.uk)

---

## Vacancies – paid & voluntary

### **Sustainable Warmth Support Officer**

£21,950 PA - Sustainable Warmth Project.

1 Year fixed contract.

An exciting new role is available working for HartlePower for further information & how to apply please visit our website

[Sustainable Warmth Support Officer](#)

---

## Your views: Consultation & feedback

## **| Hartlepower VCS News, Sector Connector Notes, Events and Funding Feedback Form |**

Thank you to all those who gave their feedback on the last Newsletter, we have taken your suggestions on board and have been working hard to implement them, like the quick navigation tab. We hope you will continue to send us feedback to make this newsletter the best it can be.

[Sector Connector Survey](#)

---

## **| Victims Commissioner Online Harms Survey |**

The survey is open to all victims of any form of online abuse and harassment. It explores the prevalence of different types of online abuse, the impact these have on the victim, and the reporting behaviours of victims. The results and findings will be published on the Victims' Commissioner website with a view to putting forward the victim perspective and informing public debate as the Online Safety Bill progresses through Parliament.

[Online Harms Survey](#)

---

## **| School Uniform Re-use Eco Shop |**

Share on Facebook Share on Twitter Share on LinkedIn Email this link

Calling all families with school-age children - we want to know if you would use a school uniform 'eco shop'?

The rising cost of living is a concern for many families and lots of us would also like to see fewer good quality, usable clothes going to waste. We are keen to know, therefore, if you would use a school uniform 'eco shop'. The shop would

rely on donations of good quality used uniform and potentially other school supplies. Items could be free to use or perhaps accept a small donation. The shop would most likely be operated by a community-based organisation in the town centre area.

Not only do uniform re-use schemes help reduce the financial costs for families of kitting out their kids, but reusing clothing that children have grown out of but which is still in very good condition is great for the planet too.

Tell us if you support the idea of a school uniform eco-shop by voting in our quick poll below.

The poll is open until **Sunday 27th February 2022.**

[Eco Shop Poll](#)

---

## [A selection of funding opportunities](#)

### [Plant the future](#)

Put down roots. Create a lasting legacy that benefits you and future generations. You could get over £10,000 for every hectare of new woodland you plant in England. Tree planting offers opportunities to diversify, generate extra income, increase farm productivity, and enhance your land – while complementing food production.

[Plant the Future](#)

---

## **Greggs Foundation**

Created to support charitable organisations in the area that helps the communities most deprived and excluded members, we offer grants of up to £20,000 a year - sometimes for as many as three years - to help cover their core running costs. This financial support helps these organisations to grow and do more good for the people they serve. Any not-for-profit organisation can apply. Find out more below.

**[North East Core Greggs Foundation Funding](#)**

---

## **Holiday Activity and Fun Programme (HAF) 2022**

Known in Hartlepool as **Hartlepool Holiday Fun**. You can find below the application and information form for 2022's programme. Application deadline is **Wednesday 8<sup>th</sup> March, 12 noon** and completed forms should be sent to **[haf@hartlepool.gov.uk](mailto:haf@hartlepool.gov.uk)**.

**[HAF Programme Information](#)**

**[HAF Application Form](#)**

---

## **Newcastle Building Society**

Is focusing on issues that address hardship including employability; debt management; food poverty; homelessness, social isolation, and cancer care &

support services. Please note applications may be considered by other Community Foundation funds.

[Newcastle Building Society Community Fund](#)

---

## **Training Opportunities**

### **Hartlepool Borough Council**

New courses are being ran by the Hartlepool Borough Council to help people gain employability skills. more will be put on over the course of the year. Check the link below to see what's on, and message Barbara for more information

Barbara Hind: [Barbara.Hind@Hartlepool.Gov.uk](mailto:Barbara.Hind@Hartlepool.Gov.uk)

[Hartlepool Borough Council Courses](#)

---

### **Practitioner Training Opportunity - Interagency Application**

Please see details below of an exciting learning opportunity available to those of you who work directly with children and their families.

If you would like to attend or know someone in your service who this would be of benefit to, please feel free to complete the application form attached and send back to [CASWORKFORCEDEVELOPMENT@hartlepool.gov.uk](mailto:CASWORKFORCEDEVELOPMENT@hartlepool.gov.uk).

## Practitioner Training Opportunity - interagency application

---

### **Debt Advice Worker- West View Advice Resource Centre**

We are looking for a motivated and enthusiastic individual, to take on the role of Debt Advice Worker

We are a well established, Quality marked, registered charity operating at various centres in Hartlepool. We are looking for this special person to join a compact, dedicated team.

Telephone Katherine Parker 01429 271275 for an informal chat or apply in writing with CV to: [Katherine@wvarc30.org.uk](mailto:Katherine@wvarc30.org.uk)

---

# Teeswide Safeguarding All

---



**Register for your  
free Safeguarding  
Adults and Children  
E-Learning at:**

[www.tsab.org.uk/training/](http://www.tsab.org.uk/training/)

**For further information please contact:**

**Safeguarding Adults Courses: [tsab.businessunit@stockton.gov.uk](mailto:tsab.businessunit@stockton.gov.uk)**

**Safeguarding Children Courses: [HSSCPtraining@hartlepool.gov.uk](mailto:HSSCPtraining@hartlepool.gov.uk)**

## Teeswide Safeguarding Adults **Training Courses**

The Teeswide Safeguarding Adults Board are offering free training online to aid the development of those working with vulnerable adults young people children and

families. This is a fantastic opportunity to help those who want to reskill or to brush up on their current skillset. To see what they have to offer, see below.

---

## Recent research

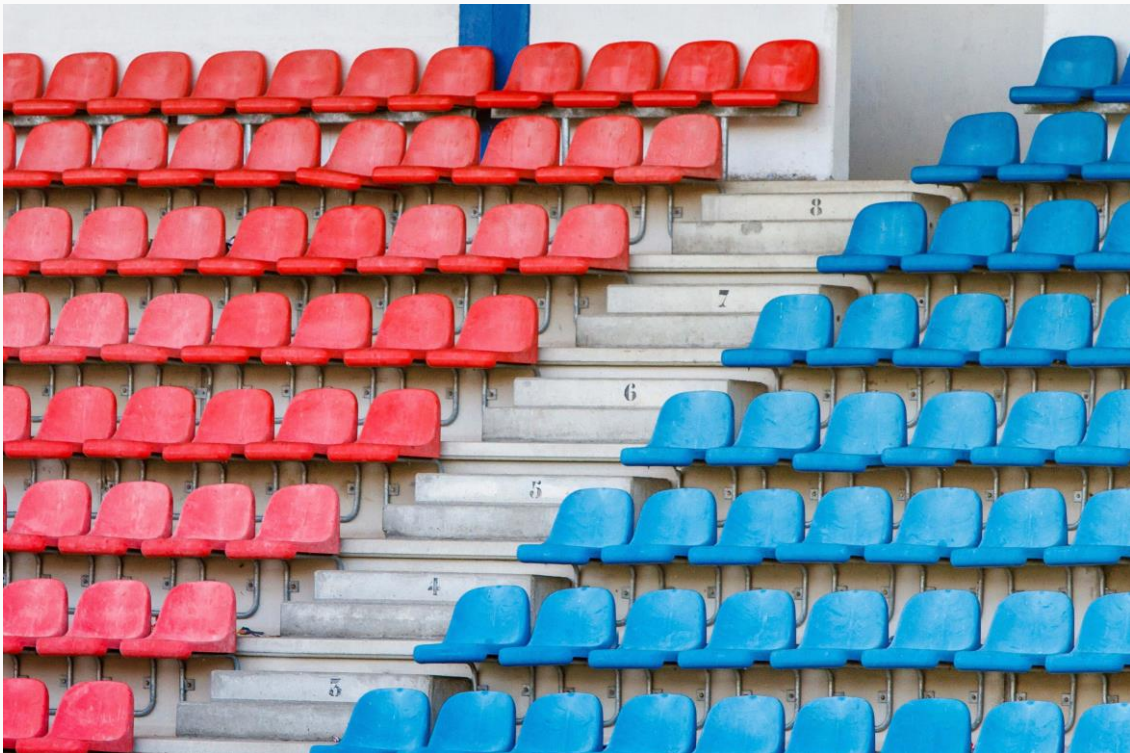

The New Economics Foundation's recently published report "Closing the Divide: How to really level up the UK" suggests that five shifts in social & economic policy are needed to "level up" those areas of the country that have suffered most from regional imbalances in prosperity – such as Hartlepool.

First, a shift away from central direction to local power and control. Setting of economic and social policy should become more localised through a radical shift of powers from Whitehall to town halls. These should be combined with strong local plans and the participation of communities and local businesses



in economic decision-making.

Second, a shift in focus from economic growth to living standards. Boosting disposable incomes and enhancing access to social infrastructure would have an immediate impact on people's living standards.

Third, a shift in focus from "high-value-added" sectors to the everyday economy that forms the backbone of local economies and generates the majority of jobs.

Fourth, a shift in focus from large businesses to the small and medium enterprises (SMEs) that form the bedrock of local economies. The vital role of SMEs in local economies is often overlooked despite their accounting for more than half of all private sector jobs.

Fifth, a major shift to green. Improvement in living standards will be only short-lived if it is built on the back of energy-intensive industries that are likely to be stranded within a decade as the world moves towards carbon neutrality. The huge investment that will be required to deliver net zero would also create the opportunity to invest in community infrastructure to create jobs, boost industries and improve neighbourhoods.

Read the report here: [Closing the divide | New Economics Foundation](#)

*"We act as though comfort and luxury are the chief requirements of life, when all that we need to make us happy is something to be enthusiastic about."*

Albert Einstein

*Copyright © 2022 Hartlepower, All rights reserved.*

You are receiving this email because you opted in via our website.

**Our mailing address is:**

Hartlepower  
81 Stranton  
Hartlepool, Hpl TS24 7QT